

maidstone street, altona

major industrial development and subdivision



client:

PaLib Group

project team:

hansen partnership

Ecology Partners

Traffix Group

Cundall

Bortolli Wellington

project description:

This project involved the redevelopment and subdivision of a strategically located industrial land parcel within the core industrial area of Altona. The 21 hectare land parcel also had the benefit of its proximity to the national rail line, Melbourne ports area and Princess Freeways, Western Highway and metropolitan ring roads. Our office led a specialized team of consultants through the planning process to achieve planning permits for the development of a major logistics warehouse and 6 lot subdivision.

Critical issues of endangered native flora and fauna removal and rehabilitation, water management, provision of infrastructure, and environmental sustainability were managed through a holistic approach incorporating sound analysis and creative thinking.

The project successfully obtained planning approval without involving an appeal at the Victorian Civil and Administrative Tribunal.

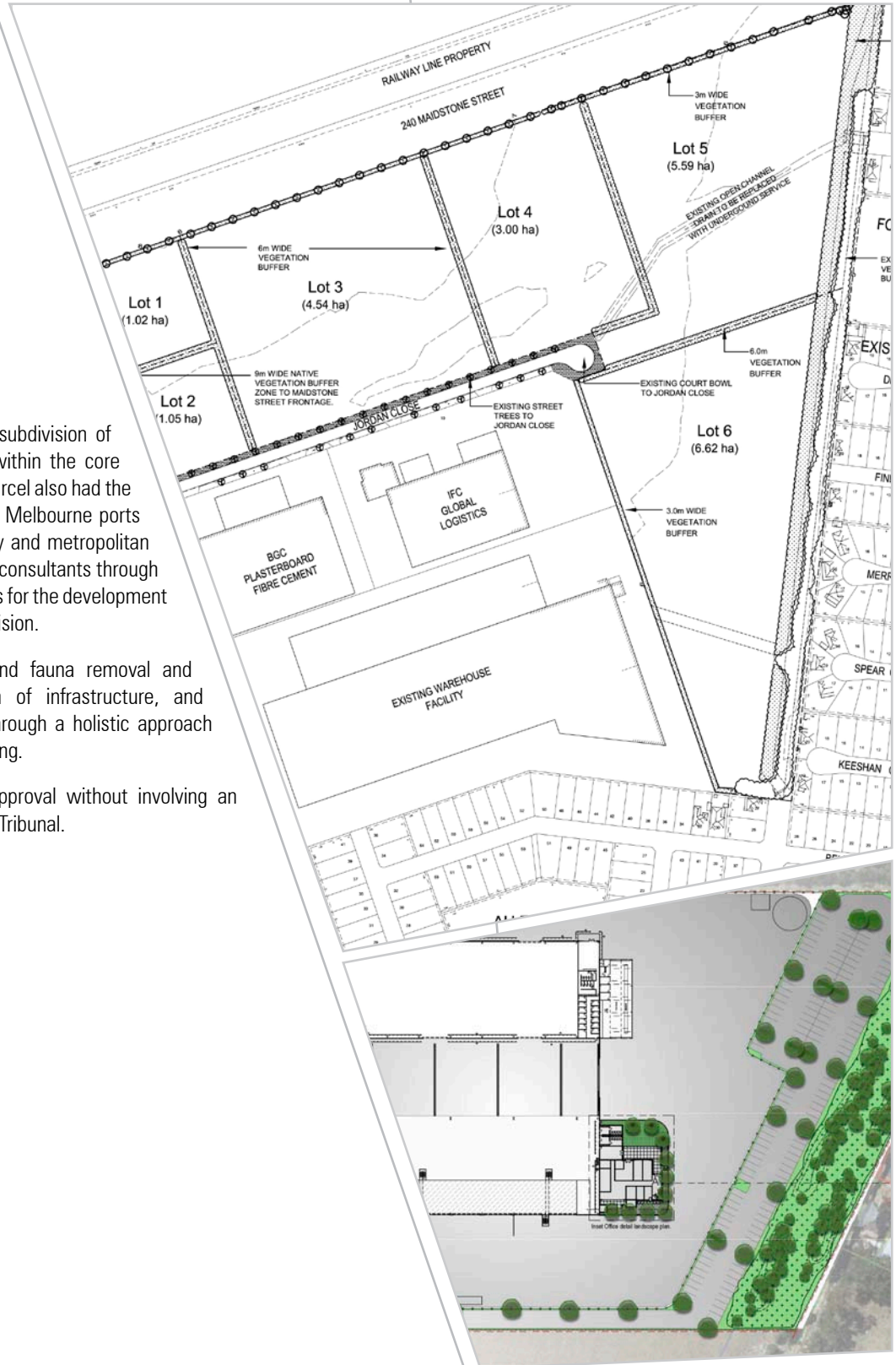

urban planning urban design landscape architecture

hansen partnership pty ltd
melbourne | vietnam
level 4 136 exhibition st
melbourne vic 3000
t 61 3 9654 8844 f 61 3 9654 8088
e info@hansen-online.com.au
w hansen-online.com.au