

mildura irymple interface strategy



client:
Mildura Rural City Council

project team:
hansen partnership

project description:
A highly collaborative and efficient process was undertaken to deliver a land use strategy for the Mildura Irymple Interface Area for the Mildura Rural City Council. The aim of this study was to resolve a future for the interface area which is located between the two townships and to investigate the relevance of achieving a sense of separation between the two towns into the future.

Integral to the formulation of this strategy was an assessment of the existing pressure for urban development within the interface area balanced against the existing and forecast supply and demand scenario for Mildura. Importantly this information was considered with the community in an interactive way to balance it against their aspirations and intentions for the evolution of the area in the future. A local planning policy was prepared to implement the key recommendations of the strategy to ensure that a clear decision making framework for future development is achieved.

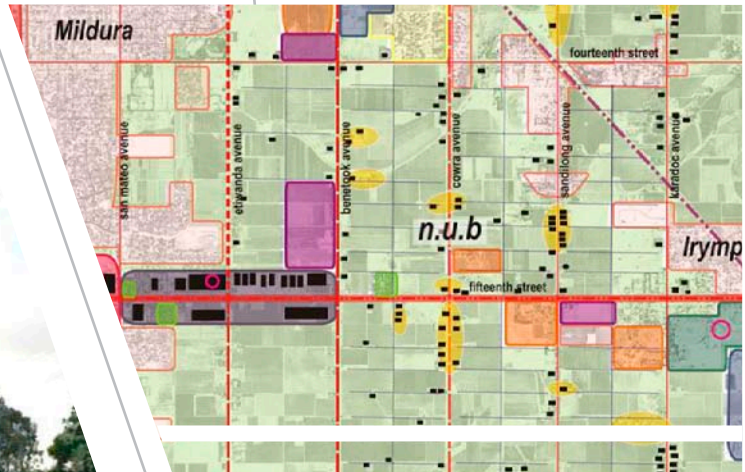
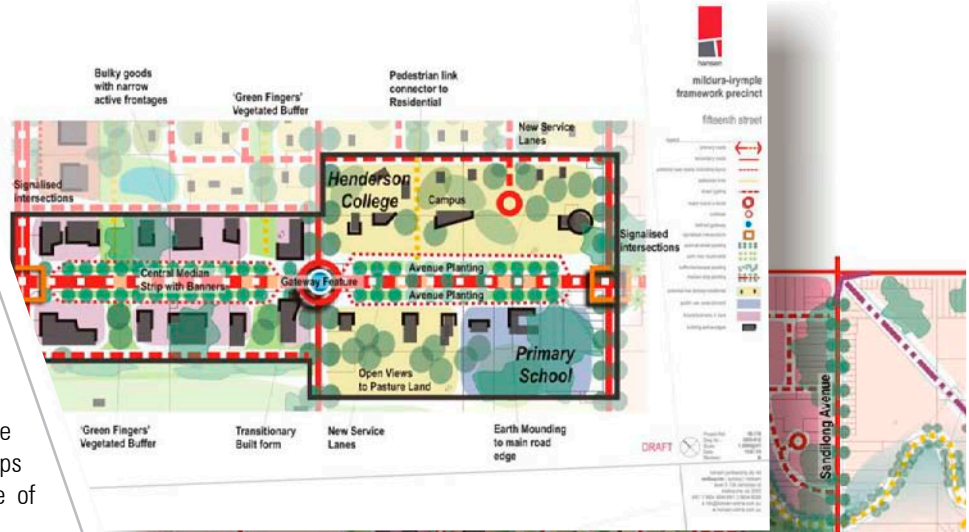

urban planning urban design landscape architecture

hansen partnership pty ltd
melbourne | vietnam
level 4 136 exhibition st
melbourne vic 3000
t 61 3 9654 8844 f 61 3 9654 8088
e info@hansen-online.com.au
w hansen-online.com.au